

3 Piece Sanitary Ball Valve
Pressure: 1000PSI (W.O.G)
Size: 1/2"-4"

**AF-61**

Features

- Blow-out proof stem.
- Built-in ISO 5211 mounting pad for easy automation.
- Straight true port for uninterrupted flow media thru the valve.
- Full port for tubing butt-weld.
- Bosses for purge connections are built into body and cap for SIP/CIP operations.
- All wetted parts are polished to 180 Grit RMS (0.51 to 0.64 micron).
- Swing-out 3pc design for easy field maintenance.
- All extend weld ends in SS 316L material allows orbital welding in place.
- High purity cleaning (oil free) and packing.

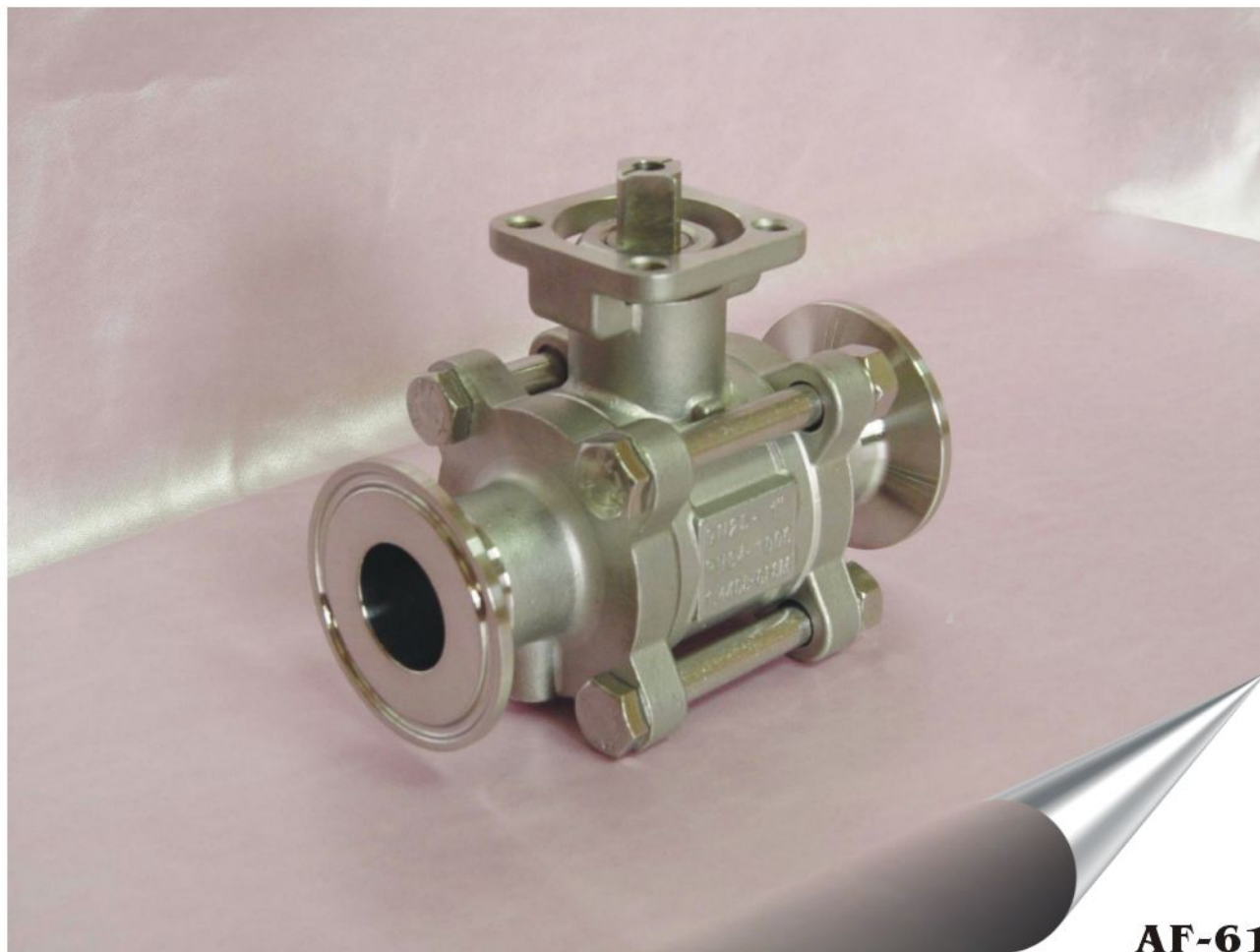

ISO 9001 REGISTERED

Material Specifications

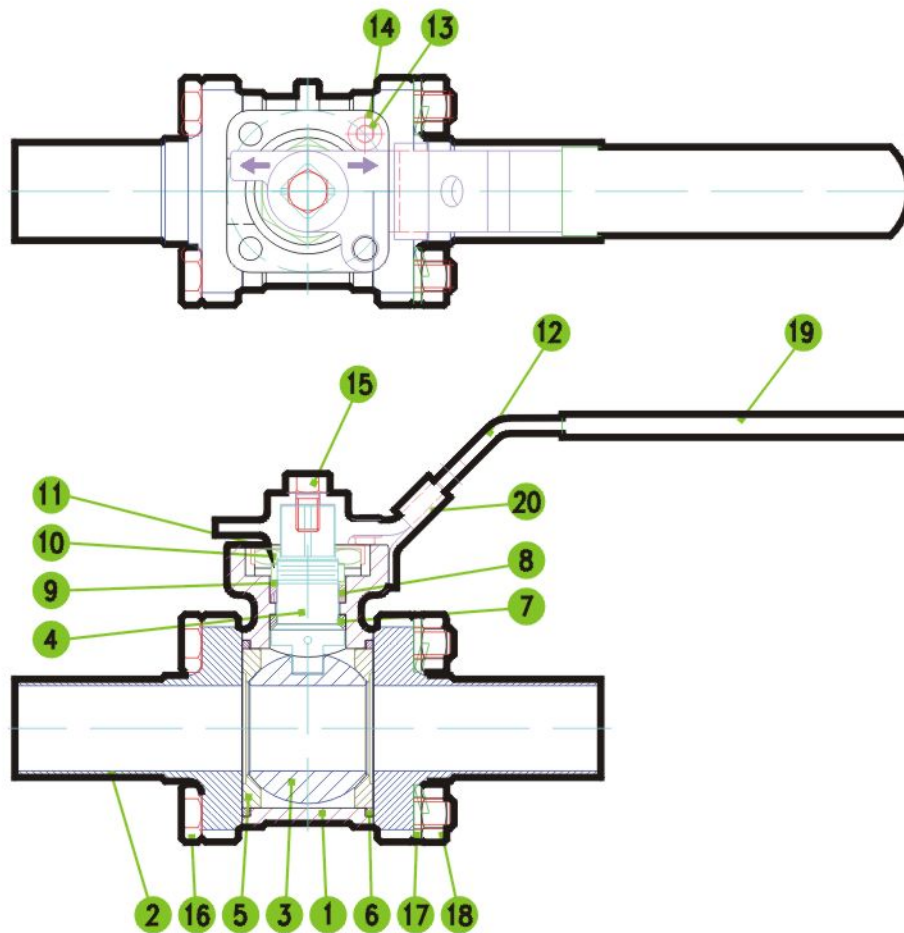

NO.	PART	STAINLESS STEEL	QTY
1	BODY	ASTM A351 Gr. CF8M	1
2	END CAP	ASTM A351 Gr. CF8M / CF3M	2
3	BALL	ASTM A351 Gr. CF8M	1
4	ANTI STATIC STEM	SS316	1
5	BALL SEAT	TFM1600	2
6	BODY SEAL	PTFE, TEFLON	2
7	THRUST WASHER	PTFE, TEFLON	1
8	STEM PACKING	PTFE, TEFLON	1
9	THRUST WASHER	50%SS, 50%PTFE	1
10	STEM NUT	SS304	1
11	LOCK SADDLE	SS304	1
12	HANDLE	SS304	1
13	STOP BOLT	SS304	1
14	STOP NUT	SS304	1
15	HANDLE BOLT	SS304	1
16	BODY BOLT	SS304	4
17	BOLT WASHER	SS304	4
18	BOLT NUT	SS304	4
19	HANDLE SLEEVE	VINYL	1
20	LOCKING DEVICE	SS304	1

Valve Dimensions

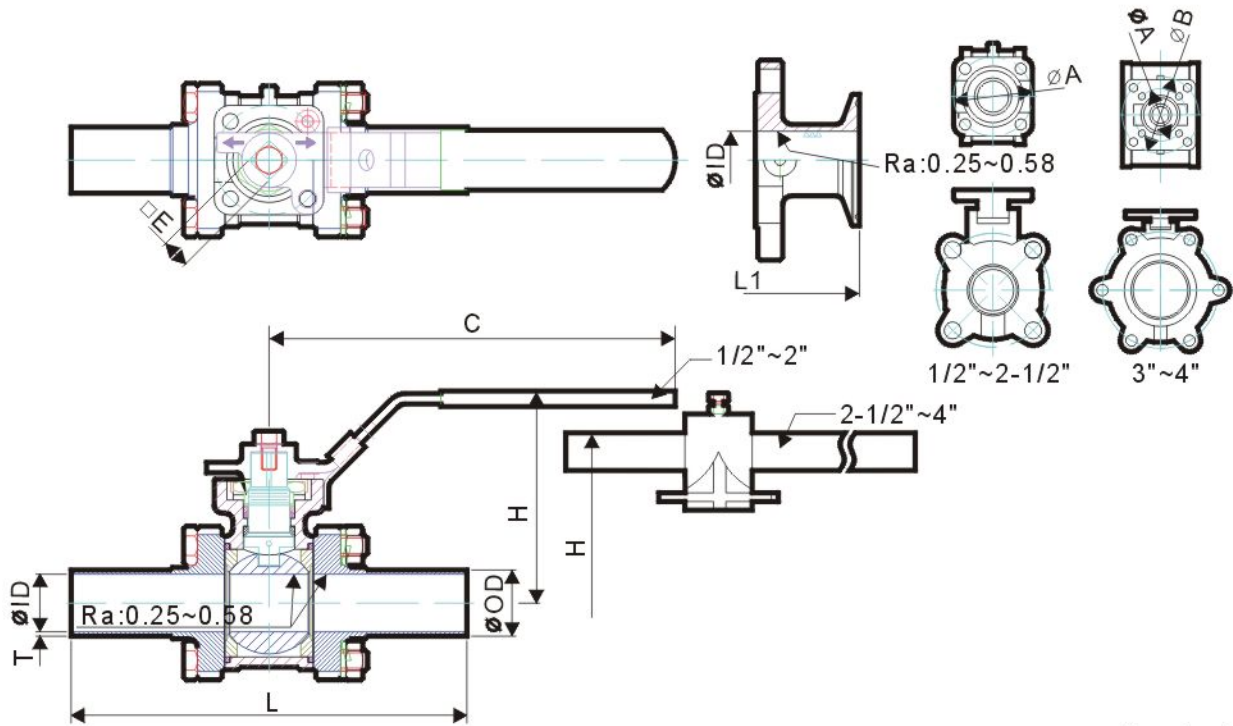

Dimension in mm

Size	∅ ID	T	∅ OD	L	L1	C	E	A	B	h	H
1/2"	9.4	1.65	12.70	135.0	93.0	126.0	9	F03	F04	8	75.0
3/4"	15.8	1.65	19.05	135.0	105.0	126.0	9	F03	F04	8	78.0
1"	22.1	1.65	25.40	152.0	114.0	156.0	11 or 9	F04	-	10 or 8	82.0
1-1/4"	28.5	1.65	31.80	157.0	120.0	156.0	11 or 9	F04	-	10 or 8	87.0
1-1/2"	34.8	1.65	38.10	190.0	124.0	181.0	14 or 11	F05	-	13 or 10	114.0
2"	47.5	1.65	50.80	204.0	145.0	181.0	14 or 11	F05	F07	13 or 10	122.0
2-1/2"	60.2	1.65	63.50	254.0	174.0	300.0	17 or 14	F07	-	16 or 13	150.0
3"	72.9	1.65	76.20	280.0	192.0	300.0	17 or 14	F07	F10	16 or 13	160.0
4"	97.4	2.11	101.60	306.0	220.0	400.0	22 or 17	F07	F10	21 or 16	189.0

How To Order

Type	Size
AF-61	03 1/2"
	04 3/4"
	05 1"
	06 1-1/4"
	07 1-1/2"
	08 2"
	09 2-1/2"
	10 3"
	11 4"

